

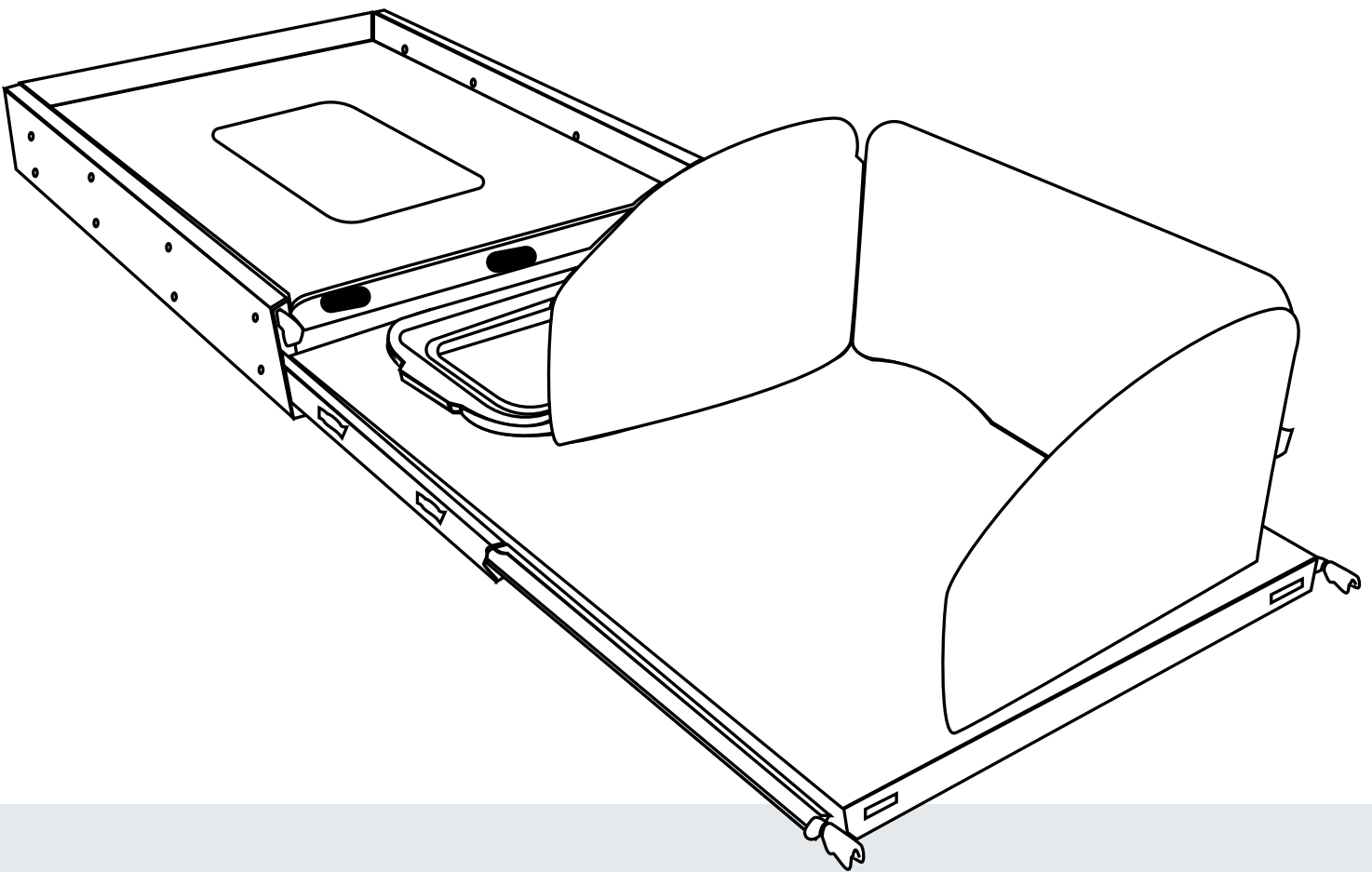

# OVS

OVERLAND VEHICLE SYSTEMS

## Large Refrigerator Tray and Sink Slide Instructions



**CAREFULLY READ INSTRUCTIONS  
PRIOR TO THE FIRST USE OF THE  
LARGE REFRIGERATOR SLIDE TRAY**

# Large Refrigerator Tray and Sink Slide

SET-UP & CARE INSTRUCTIONS

## GET TO KNOW YOUR SLIDE TRAY

We recommend you check all parts are included prior to first use.

1x Fridge Slide  
8x M6 Washers  
8x M6 Tee Nuts

8x M6 x 20mm Bolts  
8x M6 Nyloc Nuts  
4x Nylon Straps

## PREPARING FOR INSTALLATION

1

Open the slide by depressing the lock lever on both sides, then pull both the top tray and bottom slide forward to reveal the fixing holes in the side, front, and rear rails.

**NOTE:** The slide needs to be installed on a flat even surface with a minimum of 12mm thickness. You will require the use of an electric drill to install the slide.

Mark the 8 drilling points through the slide fixing holes with a permanent marker

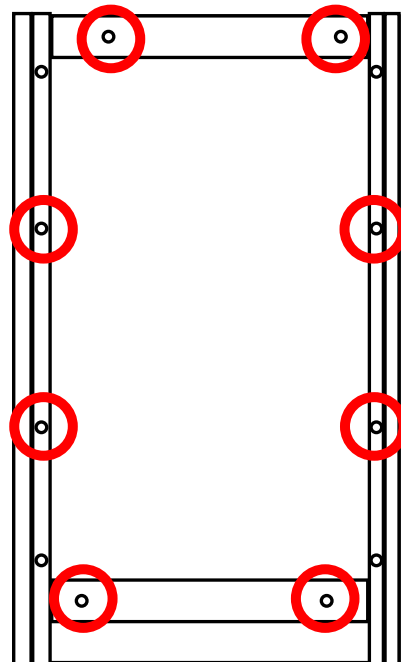
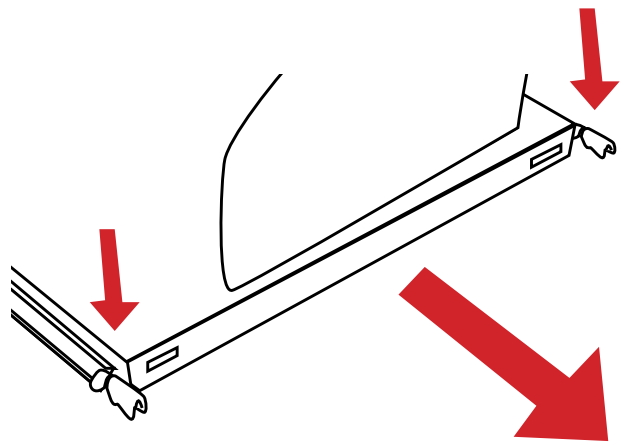

# Large Refrigerator Tray and Sink Slide

SET-UP & CARE INSTRUCTIONS

## INSTALLATION

2

**Drill 8 7mm holes for the Tee Nuts**

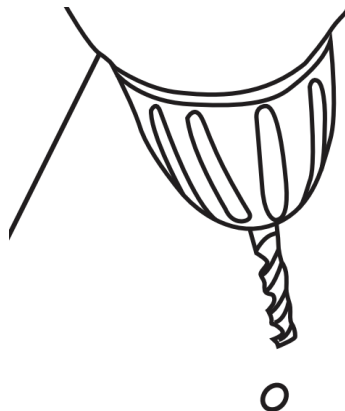

**Insert the Tee Nuts into the holes ensuring the nuts are upright and square to the hole**

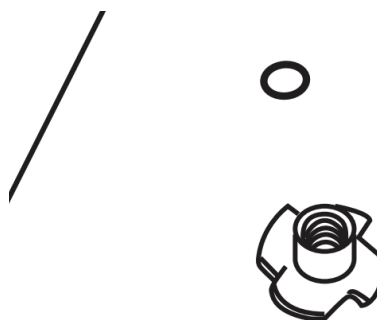

**Flatten the Tee Nuts with a mallet or hammer**

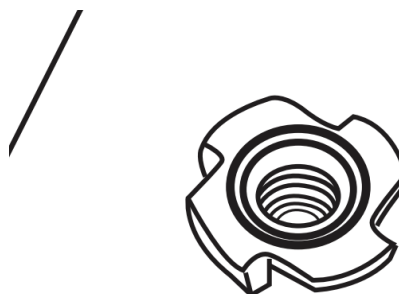

**Position the fridge slide on the flat surface.  
Use the 8x M6 bolts to fix the surface.**

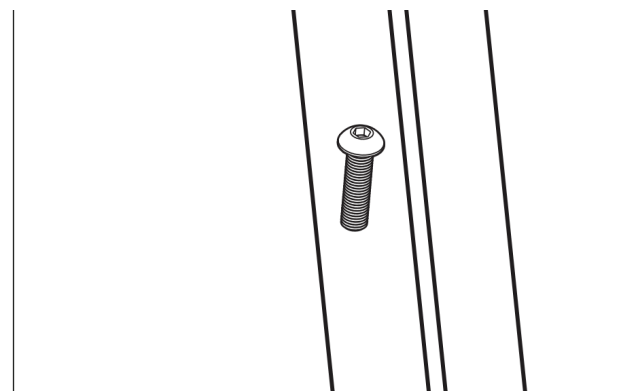

# Large Refrigerator Tray and Sink Slide

AUGUST 2025

## SET-UP & CARE INSTRUCTIONS

### CLEANING

Clean with Cold Water and Soap with a Soft Sponge

### TIE DOWN THE FRIDGE

Secure your fridge on the slide by using 4 nylon Straps supplied. Make sure the straps are secured and tight.

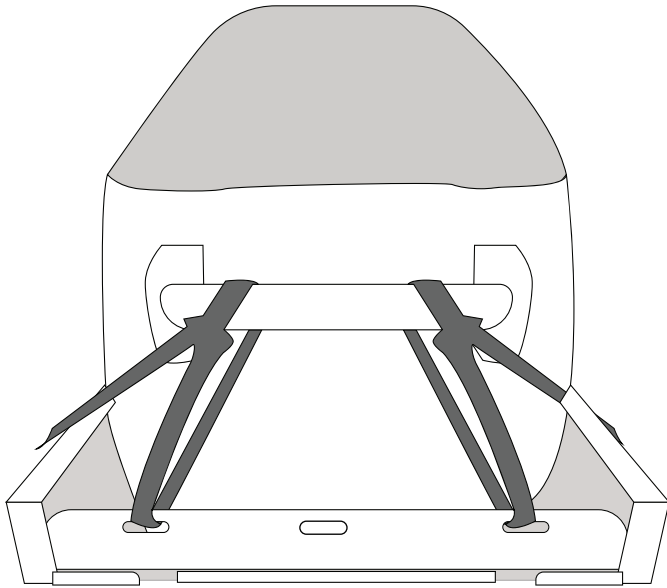

## WARNINGS

- THE SLIDE MUST BE SECURELY AND EVENLY BOLTED DOWN TO THE FLOOR OF THE VEHICLE OR TO WHEREVER THE SLIDE IS TO BE USED.
- UNDER NO CIRCUMSTANCES CAN THE SLIDE BE USED OTHER THAN WHEN IT IS FIXED DOWN CORRECTLY ON A SMOOTH EVEN SURFACE WITH NO CONTORTION OF THE FRAME.
- THE SLIDING TRAY IS ACTIVATED BY DEPRESSING THE BOTH SIDES LEVER ON THE FRONT TO PULL FORWARD AND LOCK IN.
- HEAVY PUSHING WITHOUT DEPRESSING THE LEVER WILL RESULT IN DAMAGE TO THE LEVER.
- ENSURE THAT THE TRAY IS FIRMLY LOCKED INTO PLACE WHEN RETURNING THE TRAY TO ITS INWARD POSITION.
- THIS SLIDE IS DESIGNED TO CARRY FRIDGES UP TO 80KGS INCLUDING CONTENTS AND THE SLIDING TABLE 15KG. IT IS NOT RECOMMENDED FOR COMMERCIAL USE AND NO WARRANTY APPLIES IF USED SO.



## DO YOU NEED OUR HELP?



CUSTOMER SUPPORT 833-226-4863



SALES@OVERLANDVEHICLESYSTEMS.COM

WANT TO SHOW US YOUR RIG?  
CHECK OUT OUR SOCIAL!

@overlandvehiclesystems

